

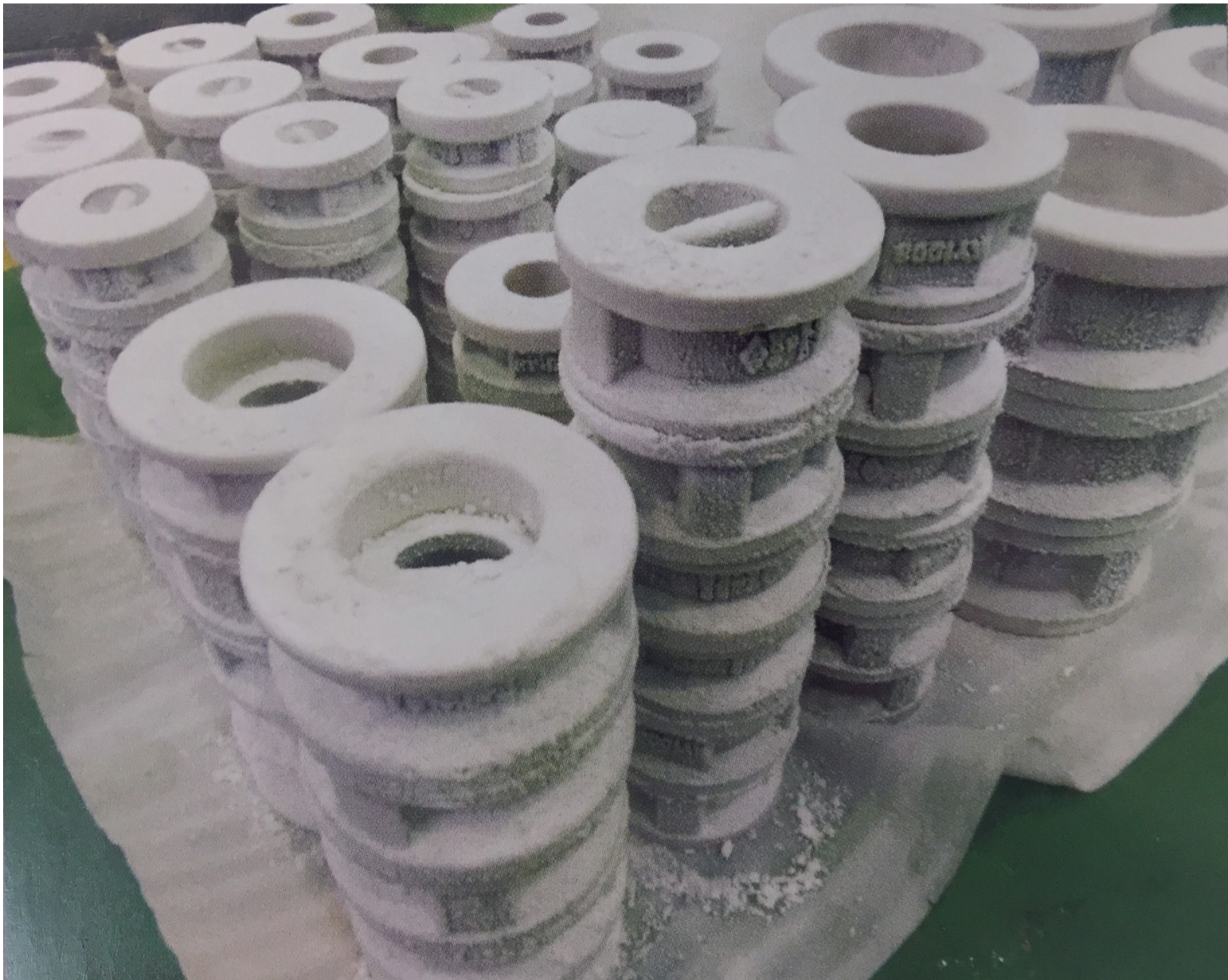

WORLD VALVE CO.,LTD

Cryogenic Butterfly Valves



Product Information



LPG Cryogenic Double Eccentric Butterfly Valve (Semi-Lug Type)

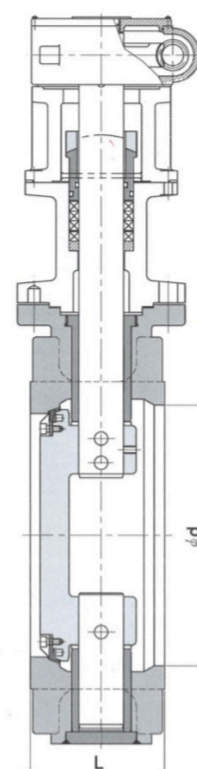
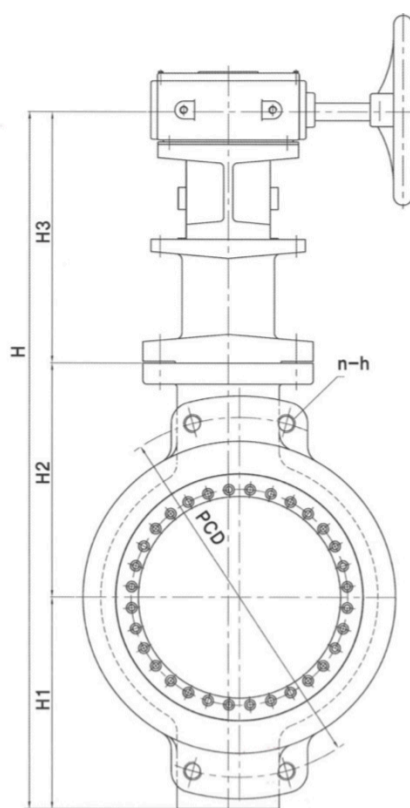

Materials (applies to all valves)		
No.	Part Name	Material
1.	Body	Ductile iron / Cast steel / Stainless steel
2.	Disc	Stainless steel
3.	Retainer	Cast steel / Stainless steel
4.	Seat	PTFE, RTFE, PCTFE
5.	Upper-Stem	Stainless steel
6.	Lower-Stem	Stainless steel
7.	Yoke	Ductile iron / Cast steel / Stainless steel
8.	Bearing	Stainless steel
9.	Bearing	Stainless steel
10.	Gasket	Non-Asbestos
11.	Bottom Cover	Cast steel
12.	Stand	Stainless steel / Ductile iron / Cast steel
13.	Packing Gland	Stainless steel
14.	Packing	PTFE, RTFE, Graphite
15.	Disc Pin	Stainless steel
16.	Gear Box	ASS'Y

Dimensions													
Size	ød	L	H	H1	H2	H3	ANSI 150LB			ANSI 300LB			Weight (approx kg)
							øC	n	150h	øC	n	300h	
80A	80	90	280	56	80	144	152.5	4	5/8	168	8	3/4	37
100A	100	90	398	85	110	203	190.5	8	5/8	200	8	3/4	41.0
125A	125	105	508	110	140	258	216.0	8	3/4	235	8	3/4	51.0
150A	150	115	662	150	175	337	241.5	8	3/4	270	12	3/4	60.0
200A	200	125	792	180	210	402	298.5	8	3/4	330	12	7/8	72.0
250A	250	135	940	220	242	478	362.0	12	7/8	387.5	16	1	120.0
300A	300	150	1082	250	283	549	432.0	12	7/8	451	16	1 1/8	150.0
350A	350	180	1200	280	310	610	476.0	12	1	514.5	20	1 1/8	190.0
400A	400	195	1310	305	340	665	539.5	16	1	571.5	20	1 1/4	265.0
450A	450	200	1414	325	370	719	578.0	16	1 1/8	628.5	24	1 1/4	338.0
500A	500	210	1554	365	400	789	635.0	20	1 1/8	686	24	1 1/4	470.0
550A	550	220	1734	410	445	879	392.2	20	1 1/4	692.15	24	1 1/4	535.0
600A	600	225	1924	450	500	974	749.5	20	1 1/4	813	3/4	1 1/2	755.0



LPG Cryogenic Double Eccentric Butterfly Valve (Flange Type)

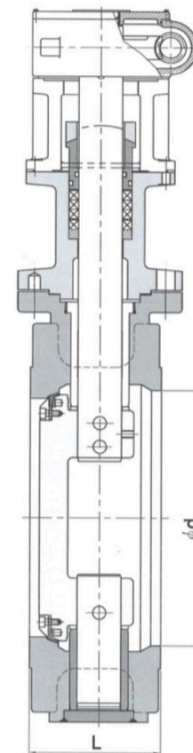
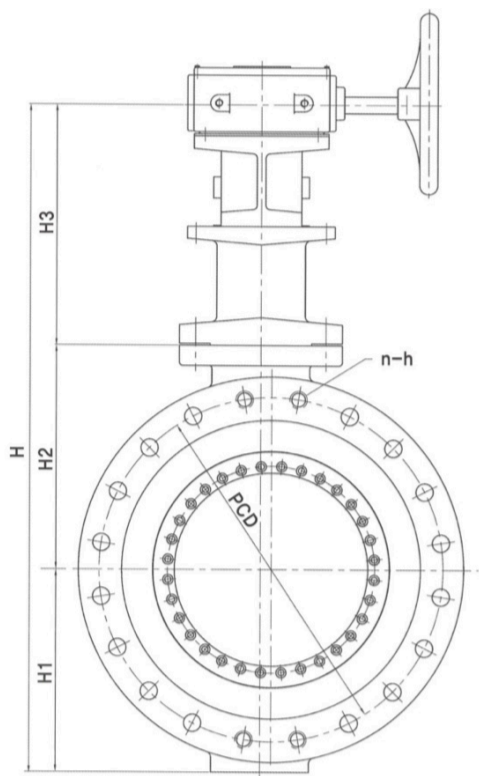

Valve Dimensions													
Size	ød	L	H	H1	H2	H3	ANSI 150LB			ANSI 300LB			Weight (approx kg)
							øC	n	150h	øC	n	300h	
80A	80	90	280	56	80	144	152.5	4	5/8	168	8	3/4	40
100A	100	136	398	85	110	203	190.5	8	5/8	200	8	3/4	48.0
125A	125	200	508	110	140	258	216.0	8	3/4	235	8	3/4	55.0
150A	150	270	662	150	175	337	241.5	8	3/4	270	12	3/4	67.0
200A	200	270	792	180	210	402	298.5	8	3/4	330	12	7/8	84.0
250A	250	300	940	220	242	478	362.0	12	7/8	387.5	16	1	132.0
300A	300	320	1082	250	283	549	432.0	12	7/8	451	16	1 1/8	170.0
350A	350	385	1200	280	310	610	476.0	12	1	514.5	20	1 1/8	215.0
400A	400	410	1310	305	340	665	539.5	16	1	571.5	20	1 1/4	285.0
450A	450	440	1414	325	370	719	578.0	16	1 1/8	628.5	24	1 1/4	352.0
500A	500	470	1554	365	400	789	635.0	20	1 1/8	686	24	1 1/4	500.0
550A	550	550	1734	410	445	879	692.2	20	1 1/4	692.15	20	1 1/4	560.0
600A	600	550	1924	450	500	974	749.5	20	1 1/4	813	24	1 1/2	790.0

Flange Dimensions													
Size	ød	L	H	H1	H2	H3	ANSI 150LB			ANSI 300LB			Weight (approx kg)
							øC	n	150h	øC	n	300h	
100A	100	136	868	110	150	608	190.5	8	5/8	200	8	3/4	51.0
125A	125	200	960	120	160	680	216.0	8	3/4	235	8	3/4	58.0
150A	150	270	1075	135	180	760	241.5	8	3/4	270	12	3/4	71.0
200A	200	210	1202	167	215	820	298.5	8	3/4	330	12	7/8	89.0
250A	250	226	1358	220	245	893	362.0	12	7/8	387.5	16	1	139.0
300A	300	242	1543	255	290	998	432.0	12	7/8	451	16	1 1/8	178.0
350A	350	290	1650	280	310	1060	476.0	12	1	514.5	20	1 1/8	230.0
400A	400	310	1878	298	375	1205	539.5	16	1	571.5	20	1 1/4	300.0
450A	450	340	2010	325	390	1295	578.0	16	1 1/8	628.5	24	1 1/4	374.0
500A	500	370	2295	370	425	1500	635.0	20	1 1/8	686	24	1 1/4	520.0
550A	550	450	2440	380	450	1610	692.2	20	1 1/4	692.15	20	1 1/4	584.0
600A	600	550	2635	425	490	1720	749.5	20	1 1/4	813	24	1 1/2	811.0
650A	650	550	2765	435	520	1810	806.5	24	1 1/4	806.45	24	1 1/2	912.0
700A	700	650	2940	480	560	1900	863.5	28	1 1/4	863.6	28	1 1/2	1320.0



LNG Cryogenic Double Eccentric Butterfly Valve (Butt-welding Type)

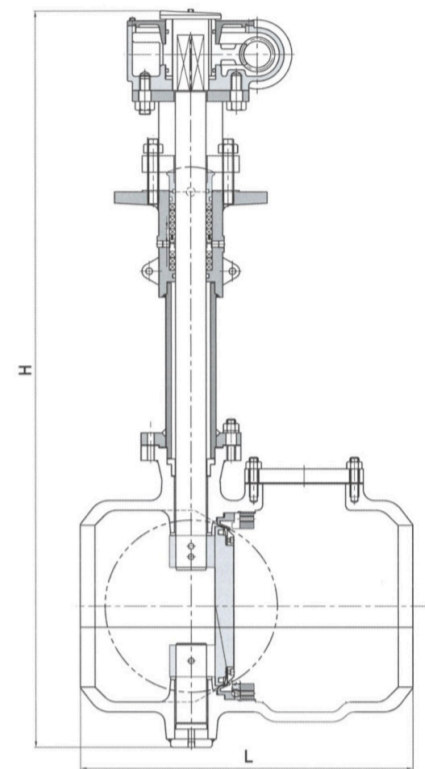
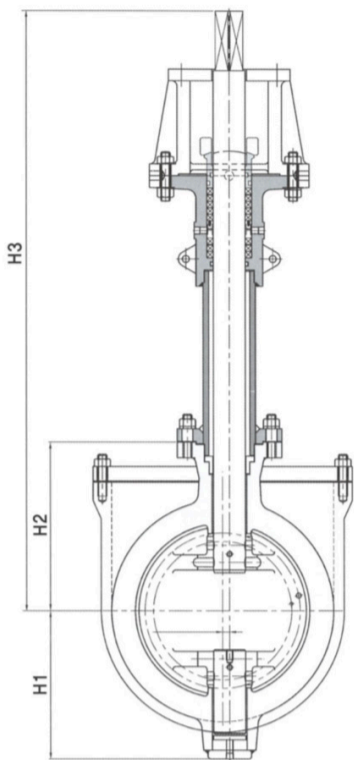

Flange Dimensions										
Size	L	H	H1	H2	H3	Top Flange				Weight (approx kg)
						TYPE	øN	øM	N - ø Z	
100A	450	868	110	150	608	F14	140	175	4-18	60.0
125A	450	960	120	160	680	F14	140	175	4-18	75.0
150A	530	1075	135	180	760	F14	140	175	4-18	97.0
200A	530	1202	167	215	820	F16	165	210	4-22	129.0
250A	565	1358	220	245	893	F16	165	210	4-22	175.0
300A	600	1543	255	290	998	F16	165	210	4-22	220.0
350A	660	1650	280	310	1060	F16	165	210	4-22	286.0
400A	680	1878	298	375	1205	F16	165	210	4-22	379.0
450A	720	2010	325	390	1295	F16	165	210	4-22	477.0
500A	765	2295	370	425	1500	F25	254	300	8-18	652.0
550A	800	2440	380	450	1610	F25	254	300	8-18	728.0
600A	840	2635	425	490	1720	F25	254	300	8-18	1032.0
650A	890	2765	435	520	1810	F25	254	300	8-18	1187.0
700A	1015	2940	480	560	1900	F30	298	350	8-23	1640.0



LNG Cryogenic Triple Eccentric Butterfly Valve (Metal Seated Butt-welding Type)

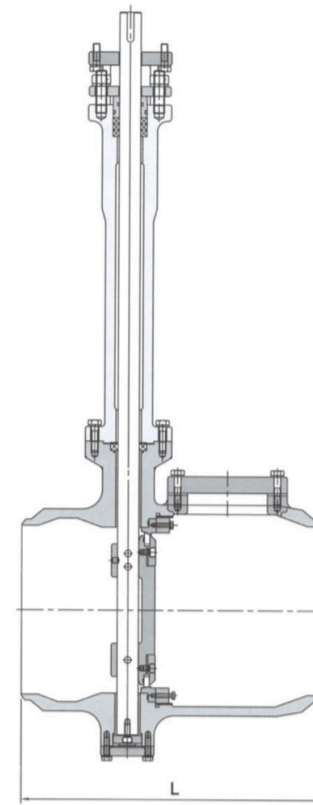
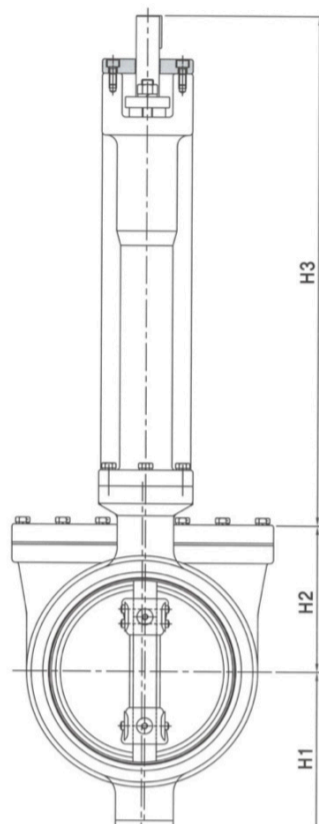

Valve Dimensions												
Size	ød	L	H1	H2	H3	ANSI 150LB (Flange)			ANSI 300LB (Flange)			Weight (approx kg)
						øC	n	150h	øC	n	300h	
100A	100	136	110	150	458	190.5	8	5/8	200	8	3/4	52.5
125A	125	200	120	160	520	216	8	3/4	235	8	3/4	59.7
150A	150	395	135	180	580	241.5	8	3/4	270	12	3/4	73.1
200A	200	410	167	215	605	298.5	8	3/4	330	12	7/8	91.7
250A	250	455	220	245	648	362	12	7/8	387.5	16	1	143.2
300A	300	480	255	290	708	432	12	7/8	451	16	1 1/8	183.3
350A	350	530	280	310	750	476	12	1	514.5	20	1 1/8	236.9
400A	400	555	341	375	830	539.5	16	1	571.5	20	1 1/4	309.0
450A	450	590	365	390	905	578	16	1 1/8	628.5	24	1 1/4	385.2
500A	500	625	410	425	1075	635	20	1 1/8	686	24	1 1/4	535.6
600A	600	680	465	490	1230	749.5	20	1 1/4	813	24	1 1/2	835.3
700A	700	750	520	560	1340	763.5	28	1 1/4	863.6	28	1 1/2	1359.6



Cryogenic Globe Valve

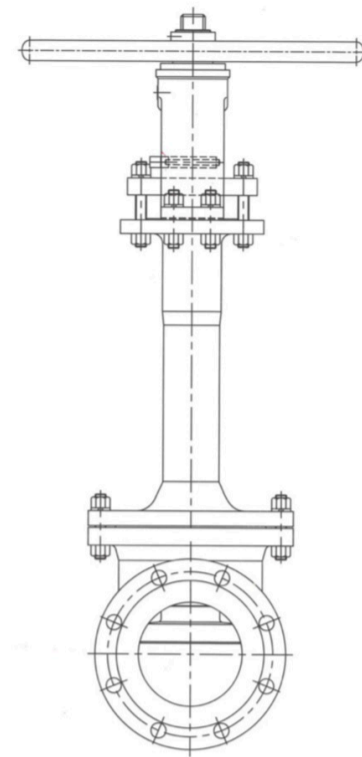
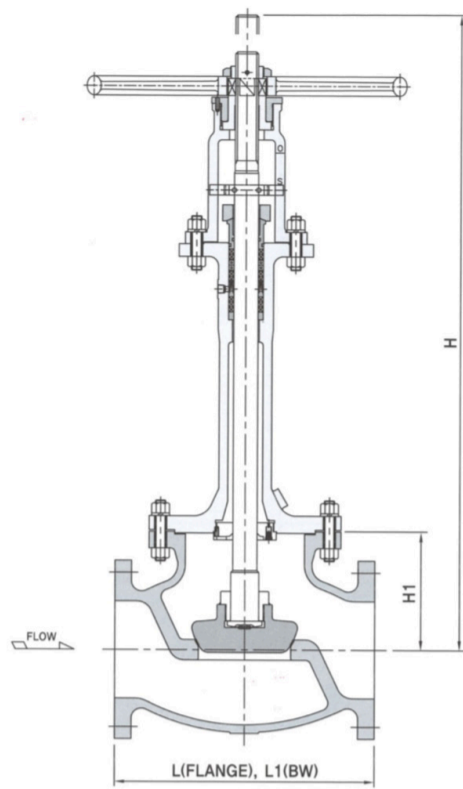

Class 150LB Valve Dimensions				
Size (mm)	L	Butt Welding (L)	H	Weight (approx kg)
50A	203	203	685	29.0
80A	241	241	765	42.0
100A	292	292	784	50.0
150A	406	406	908	135.0
200A	495	495	1168	190.0
250A	622	622	1248	320.0
300A	698	698	1447	550.0

Class 300LB Valve Dimensions				
Size (mm)	L	Butt Welding (L)	H	Weight (approx kg)
50A	267	267	775	40.0
80A	318	318	875	70.0
100A	356	356	965	106.0
150A	444	444	1105	200.0
200A	559	559	1265	350.0
250A	622	622	1460	520.0
300A	711	711	1560	860.0



Cryogenic Gate Valve

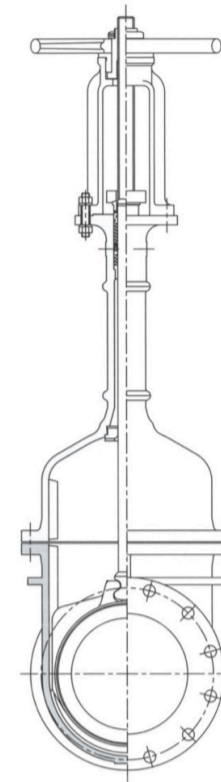
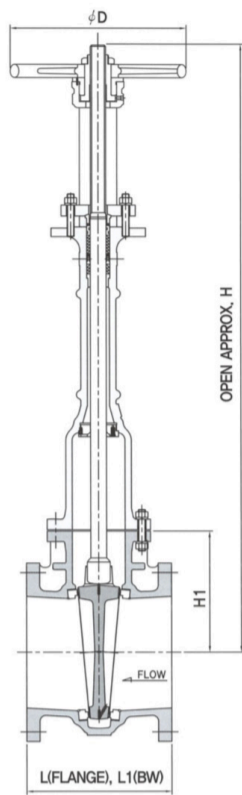

Class 150LB Valve Dimensions				
Size (mm)	L	Butt Welding (L)	H	Weight (approx kg)
50A	178	178	735	29.0
80A	203	203	855	42.0
100A	229	229	1007	50.0
150A	267	267	1190	135.0
200A	292	292	1420	190.0
250A	330	330	1670	320.0
300A	356	698	1680	550.0

Class 300LB Valve Dimensions				
Size (mm)	L	Butt Welding (L)	H	Weight (approx kg)
50A	267	267	775	40.0
80A	318	318	875	70.0
100A	356	356	965	106.0
150A	444	444	1105	200.0
200A	559	559	1265	350.0
250A	622	622	1460	520.0
300A	711	711	1560	860.0



Cryogenic Swing Check Valve

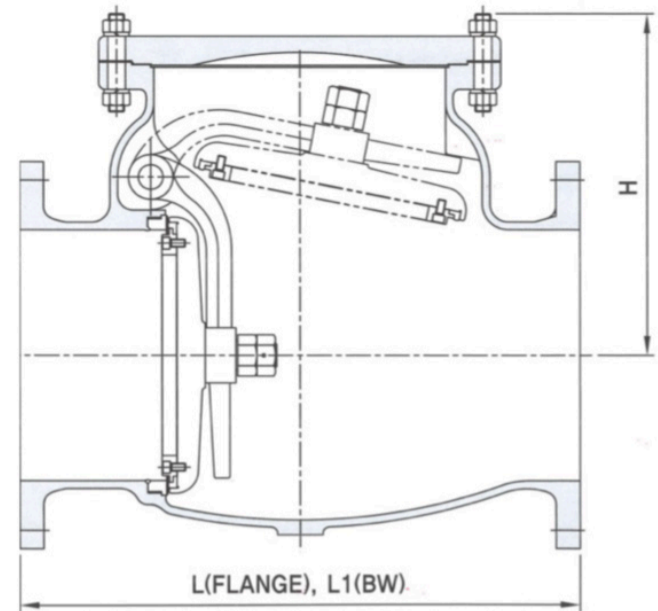
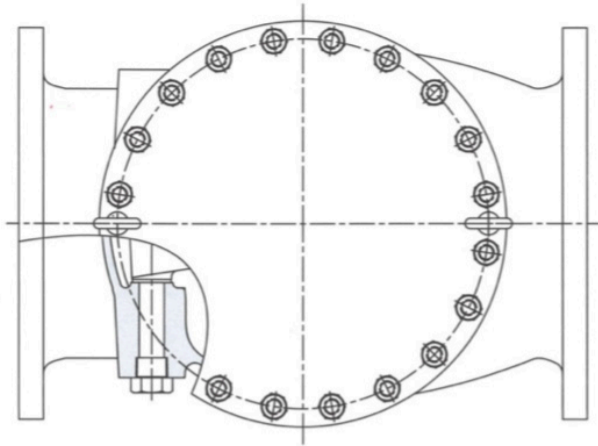

Class 150LB Valve Dimensions				
Size (mm)	Class 150			Weight (approx kg)
	L	L1	H	
50A	203	203	160	16
80A	241	241	190	30
100A	292	292	225	44
150A	356	356	260	78
200A	495	495	320	118
250A	622	622	380	236
300A	698	698	390	344
350A	787	787	405	422
400A	914	914	460	634
450A	978	978	505	816
500A	978	978	570	982
600A	1295	1295	680	1780

Class 150LB Valve Dimensions				
Size (mm)	Class 150			Weight (approx kg)
	L	L1	H	
50A	267	267	160	24
80A	318	318	199	45
100A	356	356	227	68
150A	444	444	278	137
200A	533	533	322	220
250A	622	622	383	270
300A	711	711	435	495
350A	838	838	510	680
400A	864	864	521	980
450A	978	978	572	1200
500A	1016	1016	622	1500
600A	1346	1346	712	2200